



**HERMES**  
TOOLS

Air riveter  
**R2A1/R2A2**

# Tough, Easy-to-Use, Next-Generation Air Riveter



High durability  
Hydraulic oil filling required  
less often than previous model.

In testing, less than 0.2 mm  
stroke loss after 1,000,000 strokes  
ergonomic grip

Ergonomic grip

Easy to hold and use without  
becoming uncomfortable

Rounded edges

Lightweight

Designed to be  
user-friendly



R2A1

R2A2

## Improved functionality

Long stroke  
(R2A1:19mm R2A2:25mm)



Impressively long stroke despite  
the compact size of the riveter.

Dual Material molded  
ergonomic grip



The durable rubber grip can be  
held in either hand without  
slipping or causing fatigue.

Interchangeable LR  
air supply ports



The R2A1 has air supply ports  
on both sides that can be used  
interchangeably to accommodate  
any application.

## Improved safety

### Protective cover on cylinder cup

Equipped as a standard feature, this protective cover prevents damage to the tool and workpieces.



### Mandrel shutter

As an improved safety feature, this shutter eliminates the risk of mandrels ejecting out when the tank case is not mounted on the riveter and the vacuum is off.

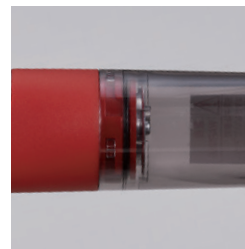

## TECHINICAL DATA

Model No.	R2A1
Product weight (kg)	1.25kg ※1
User range	Φ2.4、Φ3.2、Φ4.0、Φ4.8、( All types listed in Lobtex catalog ) *Optional support : high-strength rivets NSTB
Stroke (mm)	19 mm
Used air pressure MPa	0.5 ~ 0.6 MPa
Output	9.0kN ( Traction power at 0.6 MPa )
Sound	Pressure level ( Lpa ) 75dB or less
Air Consumption	Max. 82 L/min (Suction at 0.6 MPa)
Package Item	nosepiece ( Φ2.4、Φ3.2、Φ4.0、Φ4.8 ) , guide pipe ( Φ2.4、Φ3.2 )

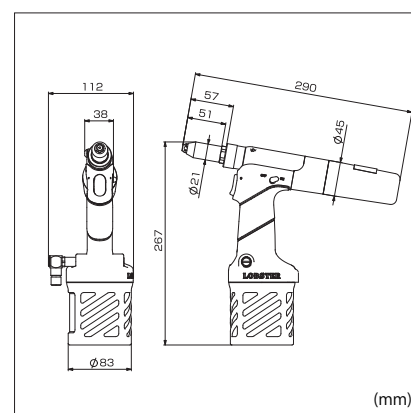

Model No.	R2A2
Product weight (kg)	2.0kg ※1
User range	Φ4.8、Φ6.4 (All type listed in Lobtex catalog) *Optional support: High-strength rivets S
Stroke (mm)	25mm
Used air pressure MPa	0.5 ~ 0.6 MPa
Output	18.5kN (Traction power at 0.6MPa)
Sound	Pressure level (Lpa) 80dB
Air Consumption	Max. 105 L/min (Suction at 0.6MPa)
Package Item	nosepiece (Φ4.8、Φ6.4)

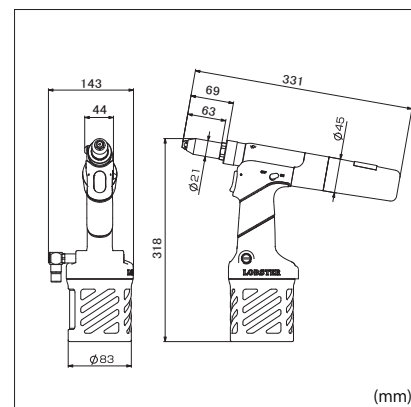

※ 1 ...Excluding cup cover

### ⚠ Caution for secure usage

- Be sure to read the instruction Manual and important Usage Advisory carefully and make sure that you understand them thoroughly before using this tool.
- Be sure to use under conditions outlined in the manual.
- Always wear eye protection when using rivet tools

- All dimensions are nominal and subject to tolerances.
- Specification are subject to change without prior notice.

View the  
Instruction  
Manual here

